



510 Mechanic Street
Leominster, Massachusetts 01453
(978) 537-5296
FAX (978) 537-1423

April 28, 2017

Town of Grafton Planning Board
Grafton Municipal Center
30 Providence Road
Grafton, MA 01519

**Re: Request for Administrative Change
SP 2016-8 & Site Plan Approval
88 Westboro Road
Grafton, MA**

FILE

RECEIVED

APR 28 2017

**PLANNING BOARD
GRAFTON, MA**

Dear Board Members:

On behalf of our client, R. P. Masiello, Inc., Whitman & Bingham Associates, LLC respectfully requests an administrative change to the approved site plans for the above referenced project. The property owner, Dana Transportation, would like to add a small addition (28-feet x 25-feet) to the approved building addition. Please refer to the attached site plan and architectural plan.

As shown on the architectural plan, the addition would be utilized to house two (2) additional storage tanks for the proposed wash water treatment system being installed as part of the project. As shown on the site plan, the addition is being placed on an area that is currently impervious (pavement) and therefore will not affect any stormwater runoff issues and/or alter any existing drainage patterns.

Thank you for your consideration on this matter. If you should have any questions or require any additional information regarding this or any other matter, please do not hesitate to contact me at my office.

Sincerely,
Whitman & Bingham Associates, LLC

Brian F. Milisci, P.E.
Principal

Enclosures

cc: Andy Smith – R. P. Masiello, Inc.
George Criswell – Dana Transportation

BFM/JER/bfm
Masiello-88 Westboro Road-Grafton-Request for Administrative Change (PB) (2).doc

RECEIVED

APR 28 2017

PLANNING BOARD
GRAFTON, MA

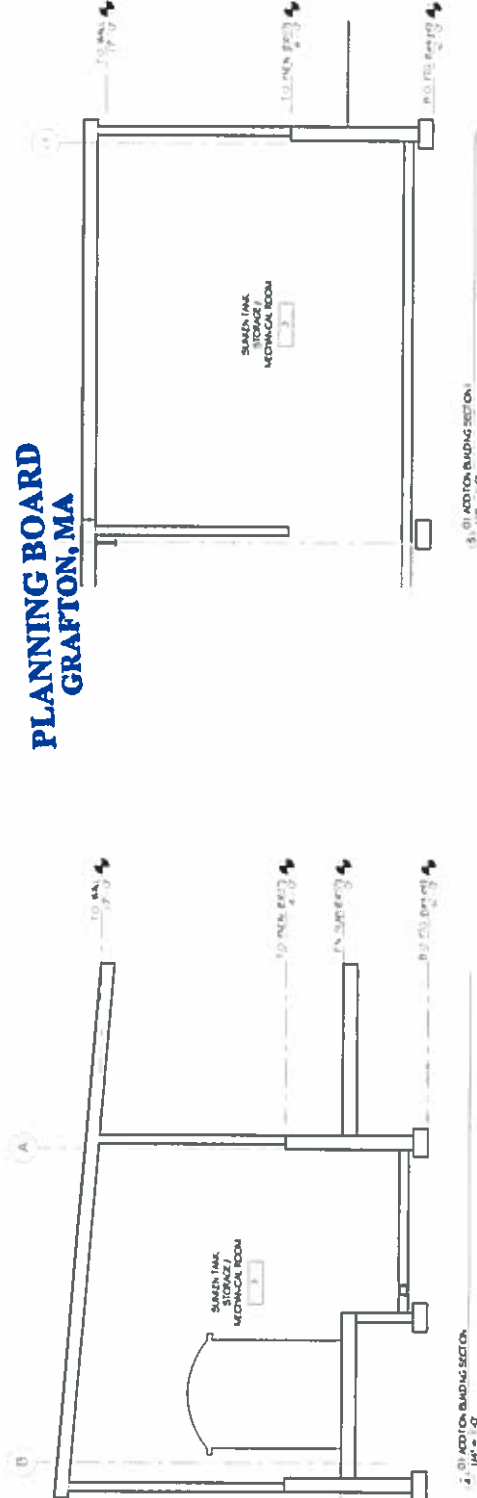

1. ADDITION BUILDING SECTION
1/4" = 1'-0"

2. ADDITION BUILDING SECTION
1/4" = 1'-0"

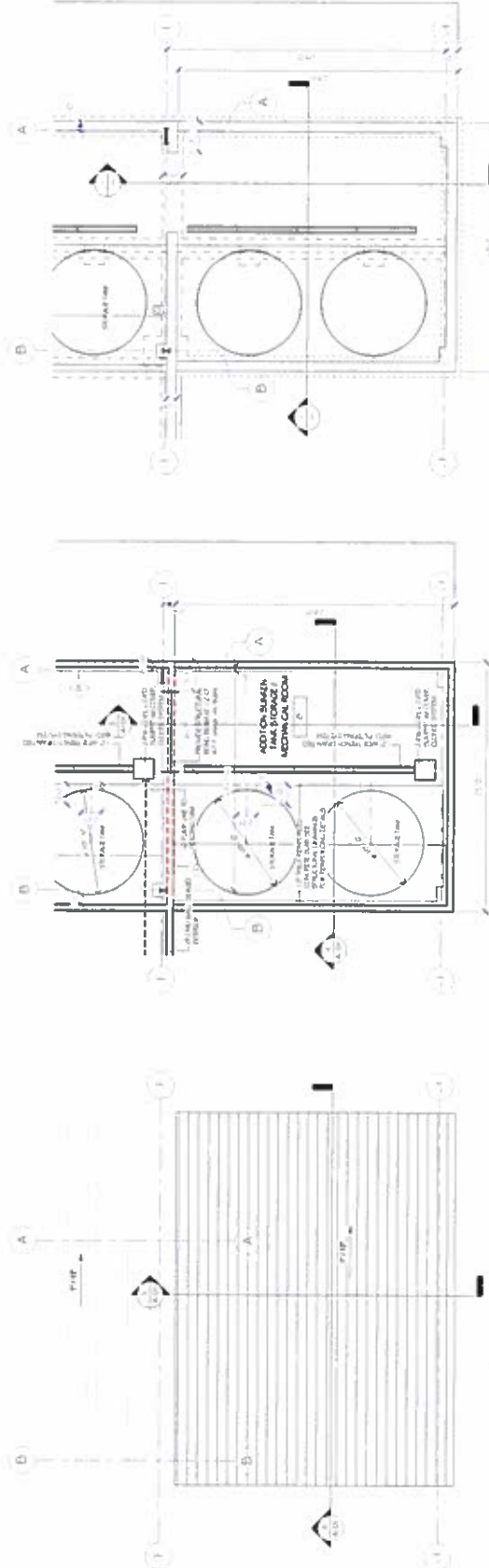

1. A100 ROOF PLAN, NEW
3/16" = 1'-0"

2. 1ST FLOOR PLAN, PROPOSED
3/16" = 1'-0"

3. FOUNDATION PLAN
3/16" = 1'-0"

The Design Studio of



Architects

875 Main Street, Suite 202, Grafton, MA 01524
781.770.1100
www.btharchitects.com

DATE: 03/20/17
DRAWN BY: J. COOPER

DANA TRANSPORT
WASH BUILDING
RENOVATION AND
ADDITION

100 WEST 36th AVE
N. WILMINGTON, MA
01971-0101
01971-0101

PER ILLUSTRATIONS, REGULATIONS AND ORDINANCES OF THE CITY OF GRAFTON, MASSACHUSETTS, AND THE STATE OF MASSACHUSETTS, THE ARCHITECT HAS PREPARED THESE CONSTRUCTION DOCUMENTS TO BE USED IN CONFORMANCE WITH THE CITY OF GRAFTON, MASSACHUSETTS, AND THE STATE OF MASSACHUSETTS, AND THE ARCHITECT HAS NO LIABILITY FOR ANY DAMAGE TO PERSONS OR PROPERTY CAUSED BY THE USE OF THESE CONSTRUCTION DOCUMENTS.

CONSTRUCTION
DOCUMENTS

1ST FLOOR PLAN

A101

RECEIVED

APR 28 2017

PLANNING BOARD
GRAFTON, MA

NO.	DESCRIPTION	DATE	BY
1	ADD REVIEW COMMENTS	03/17/16	JDN
2	ADD REVIEW COMMENTS	08/20/16	JDN
3	REVISE HOW LOCATION	12/8/16	JDN
4	ADD TYPICAL SCALING NOTE	01/17/17	JDN
5	ADD ADDITIONAL BUILDING AREA	03/08/17	JDN

PROPOSED SITE PLAN
FOR
EQUIPMENT CARE CENTER OF GRAFTON
IN
NORTH GRAFTON, MASSACHUSETTS

Prepared For:
R.P. MASELLO, INC.
38 MAIN STREET
BOSTON, MASSACHUSETTS 01505
(508) 688-9501



WHITMAN BINGHAM ASSOCIATES

ARCHITECTS & LANDSCAPERS

100 STATE STREET
SUITE 200
GRAFTON, MA 01935
TEL: (508) 881-1111
FAX: (508) 881-1123

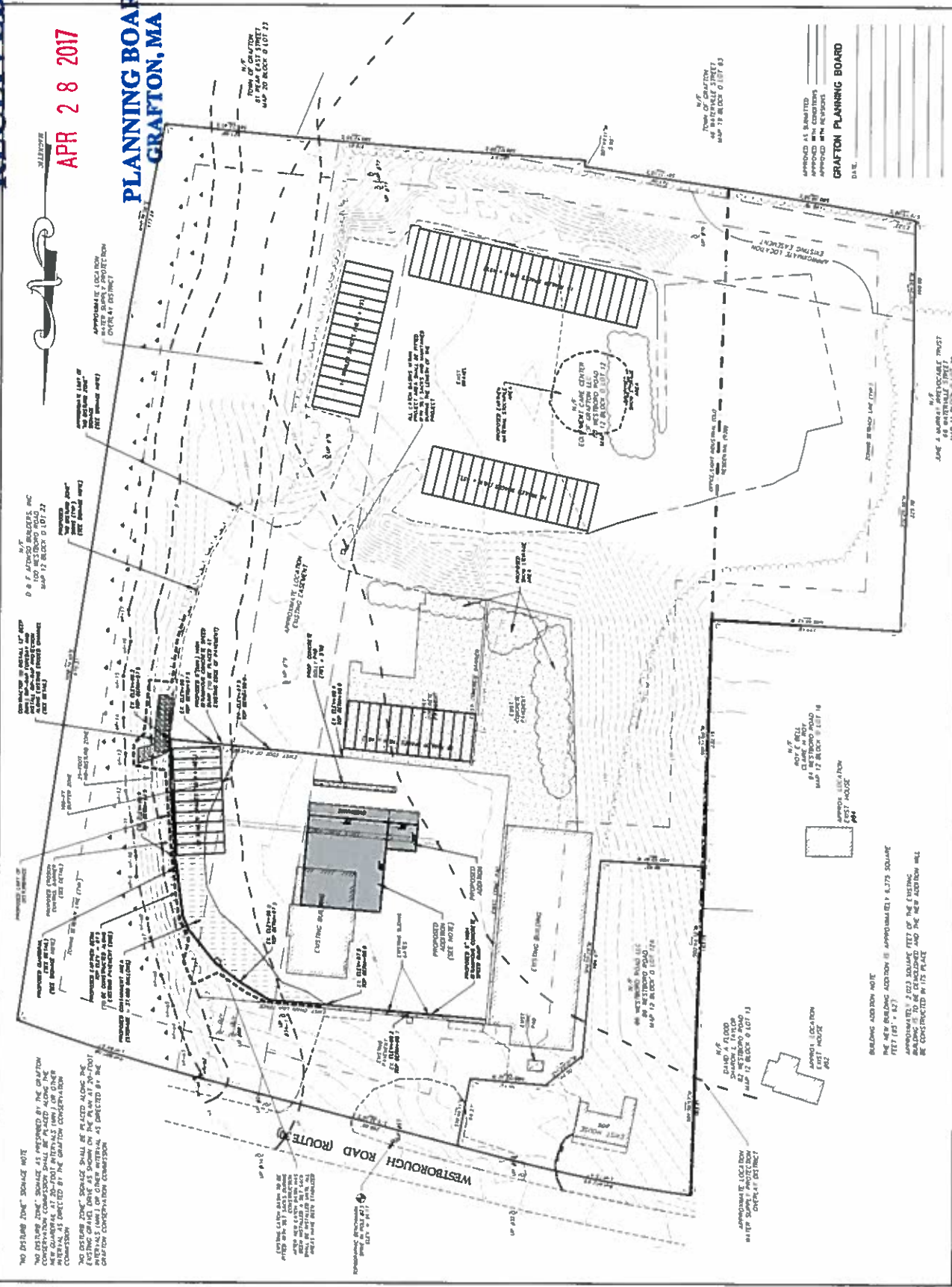

APPROVED AS SHOWN
APPROVED WITH CONDITIONS
APPROVED WITH RESERVATIONS

GRAFTON PLANNING BOARD

DATE: _____

RECEIVED

APR 28 2017



PLANNING BOARD GRAFTON, MA

NO.	DESCRIPTION	DATE	BY
1	PER PERM COMMENTS	03/17/16	BRW
2	PER PERM COMMENTS	08/20/16	BRW
3	PERM REVIEW COMMENTS	12/18/16	BRW
4	ADD TEMPORARY SCULPTING NOTE	01/17/17	BRW
5	ADD ADDITIONAL BUILDING AREA	02/08/17	BRW

PROPOSED UTILITY PLAN
FOR
EQUIPMENT CARE CENTER OF GRAFTON
NORTH GRAFTON, MASSACHUSETTS

PREPARED FOR
R. P. MASIELLO, INC.
38 MAIN STREET
BOSTON, MASSACHUSETTS 01505
(508) 689-8503



WHITMAN & BINGHAM
ASBESTOS CONSULTANTS
1200 WASHINGTON STREET, SUITE 200
BOSTON, MA 02115
TEL: 617-552-1111
FAX: 617-552-1112

APPROVED AS SUBMITTED
APPROVED WITH CONDITIONS
APPROVED WITH REVISIONS

GRAFTON PLANNING BOARD

DATE: _____

